

Connect Door Sensor to Control Panel:

The new-bought door sensors should be enrolled to the control panel before use.

For specified operation, please refer to the manual of alarm system.

Specifications:

Power Supply: DC1.5V/AA battery

Standby Current: $\leq 20\mu\text{A}$

Alarm Current: $\leq 43\text{mA}$

Wireless Transmit Distance: $\leq 80\text{ m}$ (in Open Area)

Wireless RF Frequency: 315MHz/433Hz ($\pm 75\text{KHz}$)

Temperature/Humidity: -10°C - 55°C / $\leq 80\%$ (Non-condensing)

Dimensions (L x W x H): 48 x 71 x 18mm

Wireless Door / Window Sensor User Manual

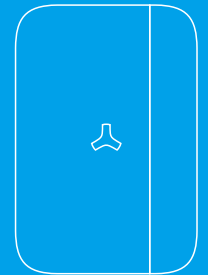

Features:

The Door/Window Sensor can be installed on doors, windows and any other objects that open and close. The sensor transmits signal to control panel when the magnet mounted near the sensor is moved away. The tamper protection ensures that sabotage attempts to move the sensor will result in an alarm activation.

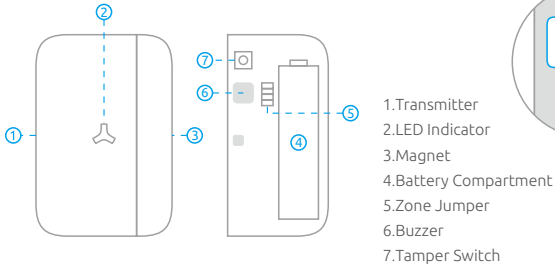

Tamper Alarm: Once intruder attempts to move the sensor, built-in buzzer beeps. The control panel will send tamper alarm message to user at the first time.

Zone Jumper: Please follow manual of alarm system for zone setup. The door sensor is set in normal zone 1 as default.

Working Status:



LED flashes once:

Door or window is opened, and the transmitter sends signal to the control panel.



LED flashes 5 times, and buzzer beeps 5 times:

Tamper alarm, low battery indication. If it's in low battery state, please replace it immediately.

Installation:

1. Open the case and install the battery properly.
2. Sensor can be installed on door or window that open and close. Make sure the installed position have been already cleaned.
3. Remove the paper strip of the double-sided tape on the back of transmitter and magnet. Carefully mount the transmitter on the door frame and the magnet on the door.
4. Keep LED Indication light  at the right direction. Make sure the magnet is on the right of the transmitter.
5. Place the transmitter in the desired location, mount the magnet no more than 1cm away from the transmitter.
6. Avoid mounting sensors in areas with a large quantity of metal and electric wiring.

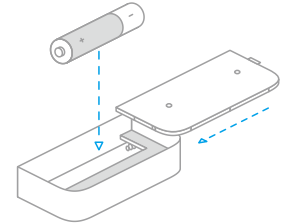
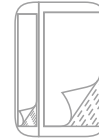

The door sensor is set in Normal Zone 1 as default. It will cause an immediate alarm if the magnet departs from the transmitter more than 2cm in arming state.

